

BTH-700

Wireless Ear Muff headset with PTT function



The **MobilitySound BTH-700** is a multi function wireless headset designed for MobilitySound's two way radio wireless audio adapter or your smart phone

Federal Communication Commission Interference Statement

This equipment has been tested and found to comply with the limits for a Class B digital device, pursuant to Part 15 of the FCC Rules. These limits are designed to provide reasonable protection against harmful interference in a residential installation. This equipment generates uses and can radiate radio frequency energy and, if not installed and used in accordance with the instructions, may cause harmful interference to radio communications. However, there is no guarantee that interference will not occur in a particular installation. If this equipment does cause harmful interference to radio or television reception, which can be determined by turning the equipment off and on, the user is encouraged to try to correct the interference by one of the following measures:

- Reorient or relocate the receiving antenna.
- Increase the separation between the equipment and receiver.
- Connect the equipment into an outlet on a circuit different from that to which the receiver is connected.
- Consult the dealer or an experienced radio/TV technician for help.

FCC Caution: Any changes or modifications not expressly approved by the party responsible for compliance could void the user's authority to operate this equipment.

This device complies with Part 15 of the FCC Rules. Operation is subject to the following two conditions:

- (1) This device may not cause harmful interference, and
- (2) This device must accept any interference received, including interference that may cause undesired operation.

This equipment complies with FCC RF radiation exposure limits set forth for an uncontrolled environment. To maintain compliance with FCC RF exposure compliance requirements, please avoid direct contact to the transmitting antenna during transmitting.

Please keep product 20cm away from your body or bystander during the radio operation.

The typical handheld two-way radios were certified under mobile usage condition (i.e.

Keep 20cm away from the user body) and use of such radio closer than 20cm may exceed the US RF exposure limit and shall be avoided.

Controls and Connection

Comfortable headband

Push-To-Talk BUTTON

When the **MobilitySound BTH-700** Bluetooth headset is paired with a **MobilitySound** Adapter, press and hold this button will start transmit voice.

POWER BUTTON

Turns the **MobilitySound BTH-700** ON and OFF . Also is used to let BTH-700 get into pairing mode so that it can be connected wirelessly to a **MobilitySound** Audio Adapter or cellular phone.

VOLUME UP/DOWN BUTTONS

These buttons can be used to adjust the volume level of BTH-700

STATUS LED

Located near the Power button. The status LED flashes messages that let the user know the current status of the device.

Calls TALK/END Button

When BTH-700 is linked with mobile phone, this button is to pick up the incoming call and hang up the call when finished.

CHARGING JACK

This mini-USB jack is used to connect the supplied charger in order to recharge the **MobilitySound BTH-700's** internal battery pack

Flexible and adjustable arm for microphone

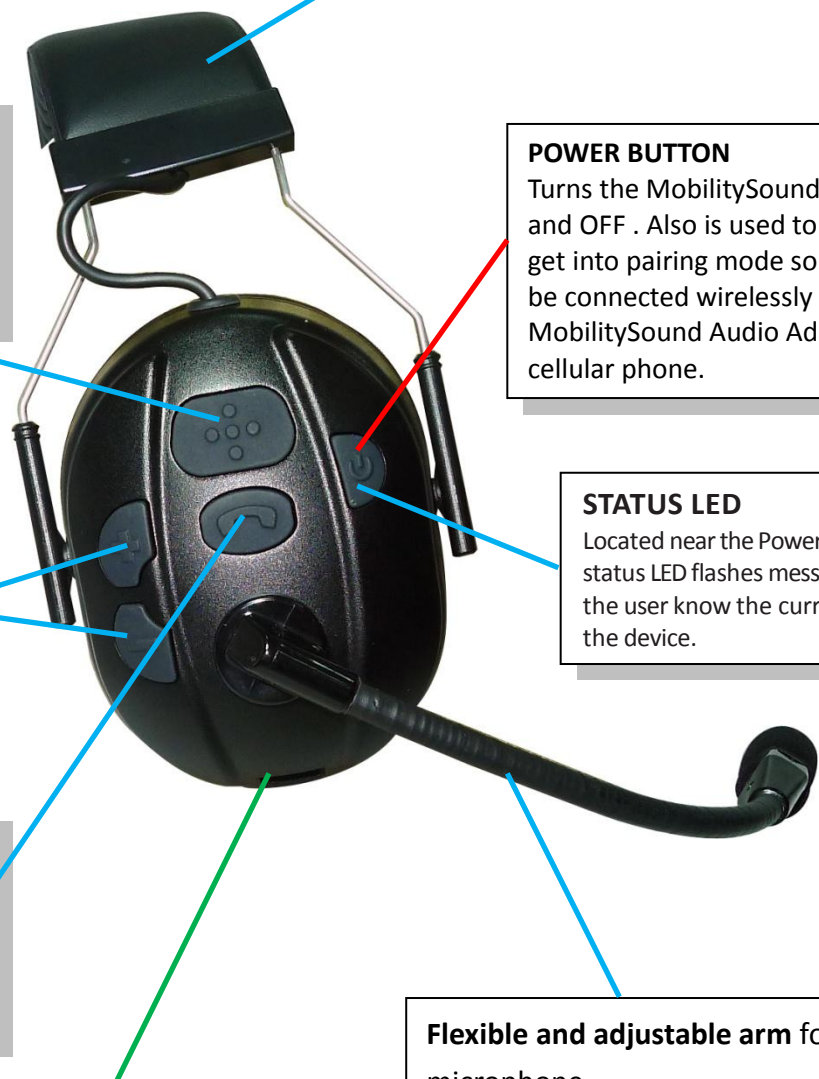

Before using BTH-700

The Mobility Sound BTH-700 has an internal Lithium-Ion rechargeable battery pack which must be charged prior to operation, and must be recharged regularly. A fully charged battery will provide approximately 12 hours (or more) of operation before needing to be recharged. However, operating time can vary depending on usage and the condition of the battery pack. Recharge the battery regularly.



Charging the BTH-700

To charge the MobilitySound BTH-700:

1. Ensure the **MobilitySound BTH-700** is turned off using the multifunction button.
2. Plug the supplied wall charger into a standard AC outlet.
3. Plug the charge cable into the AC wall charger and then into the charge jack on the side of the **MobilitySound BTH-700**. You will need to remove the protective rubber cover that is inserted into the charge jack. (To prevent dust and moisture from damaging your BTH-700, always ensure this cover is in place when you are not charging BTH-700.)
4. Once the charging process has begun, the LED indicator on the side of the **Mobility Sound BTH-700** will show a solid red light. When the battery is done charging, the LED light will then OFF.
5. Typical charge time is approximately 4 hours. Actual charge time will vary depending on several factors including the battery's charge state, condition, and age.
6. Disconnect the charger from the BTH-700 when charging is completed.

Charging Cautions:

- Use only the wall charger supplied by the manufacturer. Do not use any other charger.
- Do not use a wall charger that appears to be damaged. (Example: frayed wires, melted plastic, etc.) Contact **MobilitySound** to get a new manufacturer-approved replacement charger.
- Do not tamper with or modify the **MobilitySound BTH-700** or charger.
- Always turn the power switch to the off position when charging the **MobilitySound BTH-700**

Start using BTH-700

Pairing BTH-700 With MobilitySound Adapter (two way radio)

Step1: Pairing with a MobilitySound Audio Adapter for radios

Before pairing the MobilitySound BTH-700 with an Adapter, make sure that the BTH-700, adapter, and the two-way radio are all powered off. If your Adapter gets power directly from the two-way radio it is attached to:

- Hold down the PTT button of the **MobilitySound** Adapter then turning the two-way radio ON.
- Continue to hold the PTT button on **MobilitySound** Adapter down for approximately three seconds. Release the Talk button when the status LED on the **MobilitySound** Adapter begins to flash two times per second. The **MobilitySound** Adapter is now in audio accessory pairing mode.
- Hold down the Power Button on the **MobilitySound BTH-700**. Continue to hold the button down for approximately 5 seconds, until the LED on BTH-700 begin to quickly flash in a RED-BLUE-RED-BLUE pattern. The **MobilitySound BTH-700** is now in pairing mode.
- After a few seconds, the two devices should link to each other. Once the **MobilitySound BTH-700** and Adapter are paired, the status LED on the adapter will show a solid blue light for three seconds. The LED on the adapter will then show a periodical blue flash. The LED on BTH-700 will initially show a solid blue light.
- After successfully paired, you will be able to operate your 2-way radio using the **MobilitySound Adapter and BTH-700**.



Reconnecting to a Previously Paired Bluetooth Device:

Once the **MobilitySound BTH-700** and Adapter have been successfully paired together, both devices will remember that connection. The **MobilitySound** adapter and BTH-700 will attempt to re-establish the link automatically when the power is ON.

Testing and Using the MobilitySound BTH-700

Once your MobilitySound BTH-700 and MobilitySound audio adapter are being paired:

Received signals will be heard over the **MobilitySound BTH-700's** earphone. The volume of received calls can be adjusted using the Volume UP and Volume DOWN buttons on the **MobilitySound BTH-700**. The volume can also be adjusted using the volume control on the two-way radio (for most models).

Push-to-Talk can be activated one of several different ways:

- By pressing and holding the PTT button on the **MobilitySound BTH-700**.
- Using an optional wired PTT that is compatible with the **MobilitySound Adapter**.
- Using an optional **MobilitySound** Wireless Bluetooth PTT (model BT-PTT or BT-PTT2, sold separately).

Note that if you are using a wireless Bluetooth PTT, you will first need to pair the adapter with the PTT using the instructions located in the **MobilitySound PTT User's Guide**.

When transmitting, the type of audio accessory that is connected to the **MobilitySound BTH-700** determines which microphone will be selected as the audio source.

If a listen-only earphone is used, transmit audio is taken from the internal microphone in the **MobilitySound BTH-700**.

If an audio accessory that has both an earphone and microphone is used, transmit audio is taken from the accessory microphone.

Operate the BTH-700 and STATUS LED MESSAGES

The meanings of the various status LED messages indicated by the **MobilitySound BTH-700** are shown on the following table:

State and Action	LED MESSAGE	MEANING
BTH-700 neither linked nor paired		
Device is off	No indication	BTH-700 is off
When device is off, press power key for 3 seconds	Solid Blue & Red LED ON for 1 second then OFF	BTH-700 is ON
When device is off, press power key for 6 seconds	Blue & Red LED flashes alternatively	Get BTH-700 into pairing mode
When device is ON, press power key for 3 seconds	Red LED flashes 3 times then off	Turn BTH-700 off
Device ON, no paired or lost link	Blue LED flashes once every 2 seconds	Not paired or lost link
BTH-700 linked with audio adapter only		
Single link with dongle	Blue LED flashes once every 6 seconds	Linked with adapter only
Press/release the PTT button	When PTT pressed, Red LED solid ON, OFF when released	Linked with dongle
Press the volume keys	Blue LED flashes once every 6 seconds	Adjust audio dongle volume

STATUS LED MESSAGES TABLE(CONTINUED)

BTH-700 linked with cell phone only		
Press the TALK/END key	Blue LED flashes once every 6 seconds	If paired with iPhone, this will start/stop the music playing
Music is playing, press the volume keys	Blue LED flashes once every 6 seconds	Adjust the music volume of iPhone
Music playing, double press the volume keys	Blue LED flashes once every 6 seconds	Skip to Next/Previous track
Linked with iPhone, press TALK/END key when a incoming call	Blue LED flashes once every 6 seconds	Will Talk/End the call, the music will stop during the call and resume when call ends
During the call, press volume keys	Blue LED flashes once every 6 seconds	Adjust the speaker volume of the cell phone
Stand by mode, double press TALK/End key	Blue LED flashes once every 6 seconds	Redial last number
Charging BTH-700		
During charging	Red LED continuous ON	
Charging complete	No LED ON	
Low battery	Red LED flashes once every 6 seconds	With beep sound every 6 seconds
Volume adjust		
Volume UP		5 steps in volume adjust, when reach the max volume, a long beep is heard
Volume down		5 steps, when reach the min volume(Mute), a short beeps is heard

Using the BTH-700 with a Smart Phone or MP3 Player

Although the **MobilitySound BTH-700** Bluetooth headset is primarily designed for two-way radio use, it can be paired to a Bluetooth enabled cellular phone or MP3 player in place of a standard Bluetooth headset. In order to pair your BTH-700 and cellular phone, do the following:

- First, activate the Bluetooth feature of your cellular phone using the instructions provided by the manufacturer. For most phones, select Settings/Tools > Connections > Bluetooth > On See your phone's user guide for more information.
- Hold down the Multifunction Button on the MobilitySound BTH-700. Continue to hold the button down for approximately 3 seconds, until the LED on the BTH-700 begins to quickly flash in a RED-BLUE-RED-BLUE pattern. The MobilitySound Adapter is now in pairing mode.
- On your phone, chose the newly discovered Bluetooth device (device name "BTH-700") as the active connection. See your phone's user guide for more information.
- If prompted for the Passkey (PIN code), enter 0000. Pairing is successful! You should now be able to use the MobilitySound BTH-700 with your cellular phone.

Note that the MobilitySound BTH-700 does support pairing to multiple devices. You can pair BTH-700 with a MobilitySound Adapter / two-way radio OR with a cellular phone.

When connected with a cellular phone, the **Talk/End** Button of the **MobilitySound BTH-700** has the following functions:

CALL STATE	BUTTON PRESS	FUNCTION
Incoming call	Press TALK/END Button once	Answer call
Incoming call	Long press(5 seconds) on TALK/END button	Reject call
On a call	Press TALK/END Button once	End the call
No call	Double press TALK/END button	Redial last number

When used with an MP3 music player, the following buttons on the **MobilitySound BTH-700** have different functions as well:

BUTTON	FUNCTION
Talk/End Button	Play / Pause music
Volume Up	Adjust music volume up
Volume Down	Adjust music volume down
Press Volume Up twice	Skip to previous track
Press Volume Down twice	Skip to next track

Note that you should set the volume level on the MobilitySound BTH-700 using the Volume Up / Volume Down buttons before connecting the BTH-700 to a MP3 music player since the volume control functions are remapped when a music player is connected.

SPECIFICATIONS

Dimension	220mm X 130mm X 90mm
Weight	350g
Version	3.0
Profiles	HSP, HFP, A2DP, AVRCP
R.F. Spec	Class 2
Power	Max 4dB
Sensitivity	-90dB
Range (typical)	10 meters
Built-in Battery	330 mAh
Standby Current	6mA
Standby Time	50 hours
Average Talk Time	10 hours
Operating Temp. Range	-15° C to +50° C

Notice : The changes or modifications not expressly approved by the party responsible for compliance could void the user's authority to operate the equipment.

IMPORTANT NOTE:

To comply with the FCC RF exposure compliance requirements, no change to the antenna or the device is permitted. Any change to the antenna or the device could result in the device exceeding the RF exposure requirements and void user's authority to operate the device.

SUPPORT AND WARRANTY

MobilitySound Radio Products warrants this product against defects in materials or workmanship for a period of **one year** from the date of retail purchase. **MobilitySound** will repair or replace a defective unit, at our option, without charge for parts or labor. The limited warranty is extended only to the original purchaser. It does not cover damage or failure caused by or attributable to Acts of God, abuse, misuse, improper or abnormal usage, faulty installation, improper maintenance, lightning, or other incidences of excessive voltage, or any tampering or repairs by other than a **MobilitySound** authorized repair facility. It does not cover replacement of consumable parts, transportation costs, or damage in transit.

Repair or replacement under the terms of this warranty does not extend the terms of this warranty. This warranty can only be modified by an officer of **MobilitySound** Radio Products, and then only in writing. Should this product prove defective in workmanship or material, the consumer's sole remedies shall be such repair or replacement as provided by the terms of this warranty. Under no circumstances shall **MobilitySound** Radio Products be liable for any loss or damage, direct, consequential, or incidental, arising out of the use of or inability to use this product. Some states do not allow limitations on how long an implied warranty lasts or the exclusions or limitations of incidental or consequential damages, so the above limitations or exclusions may not apply to you. This warranty gives you specific legal rights. You may also have other rights, which may vary, from country to country.

For support or warranty service on your **MobilitySound** product, visit us on the web at <http://www.MobilitySound.com>

COPYRIGHT AND TRADEMARK INFO

© 2015 **MobilitySound** Products, All rights reserved.

MobilitySound® is trademarks owned by **MobilitySound** Radio Products. All other products or service names are the property of their respective owners.

DISCLAIMER: The Bluetooth wireless link used by **MobilitySound** products is an open standard, unsecured technology. As such, it is not recommended for first-responder or other mission critical users.