

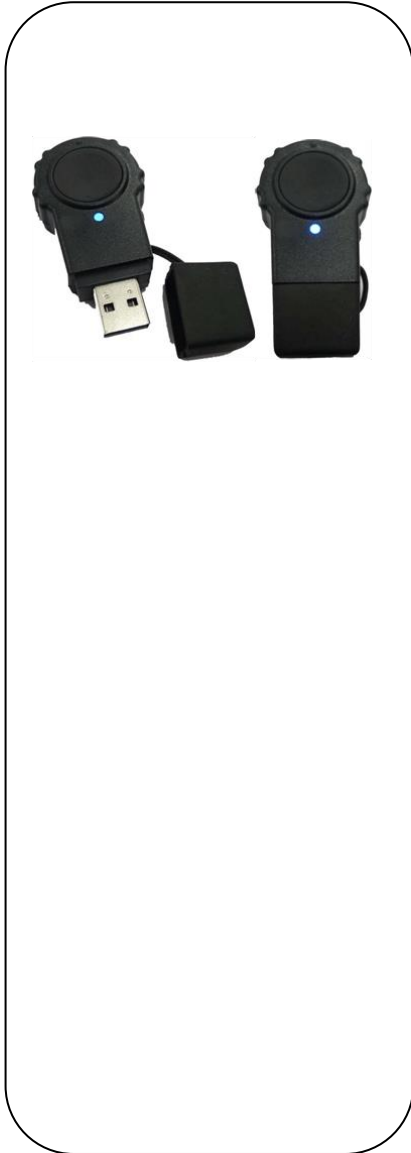

MobilitySound PTT-220-VZ



Bluetooth PTT for Zello

Bluetooth type PTT for connecting POC APPs

Type:	Bluetooth PTT
Operating Temp:	-20°C±2°C ~ 50°C±2°C
Storage Temp:	-40°C±2°C ~ 80°C±2°C
Approx. Weight:	14.5g

Specification

- Fully Qualified Bluetooth v2.1
- Chip set : CSR BC5 + 16MB external Flash
- Receiver Sensitivity: -82 dBm (typ.)
- PTT function built-in
- Power class 2,10 meters
- Display: Two color LED
- Support: SPP Profile
- DC Input: 5 VDC (std.)
- DC Current: 16 mA (avg.)
- DC Current: 20 mA (transient)
- Battery: 240mAh
- Use Time: 15 Hours (MAX)
- Charging Type: USB

BT-PTT2 Option

Option Velcro belt type

Option Clip type



MobilitySound PTT-220-VZ

User Manual (Android)

1. Press the PTT button and then hold down the power button. When the LED of PTT-220-VZ flashes 2 times every second, it is in the pairing mode now.



2. Get in “Settings – Bluetooth” on the smartphone (take LG smartphone for example) and wait for the “PTT-220” to be found. Select “PTT-220”. Though the “PTT-220” doesn’t show “connecting”, it is normal.

(NOTE: if the PTT-220-VZ lost the link with “Zello”. Go to settings power off/on Bluetooth again.)

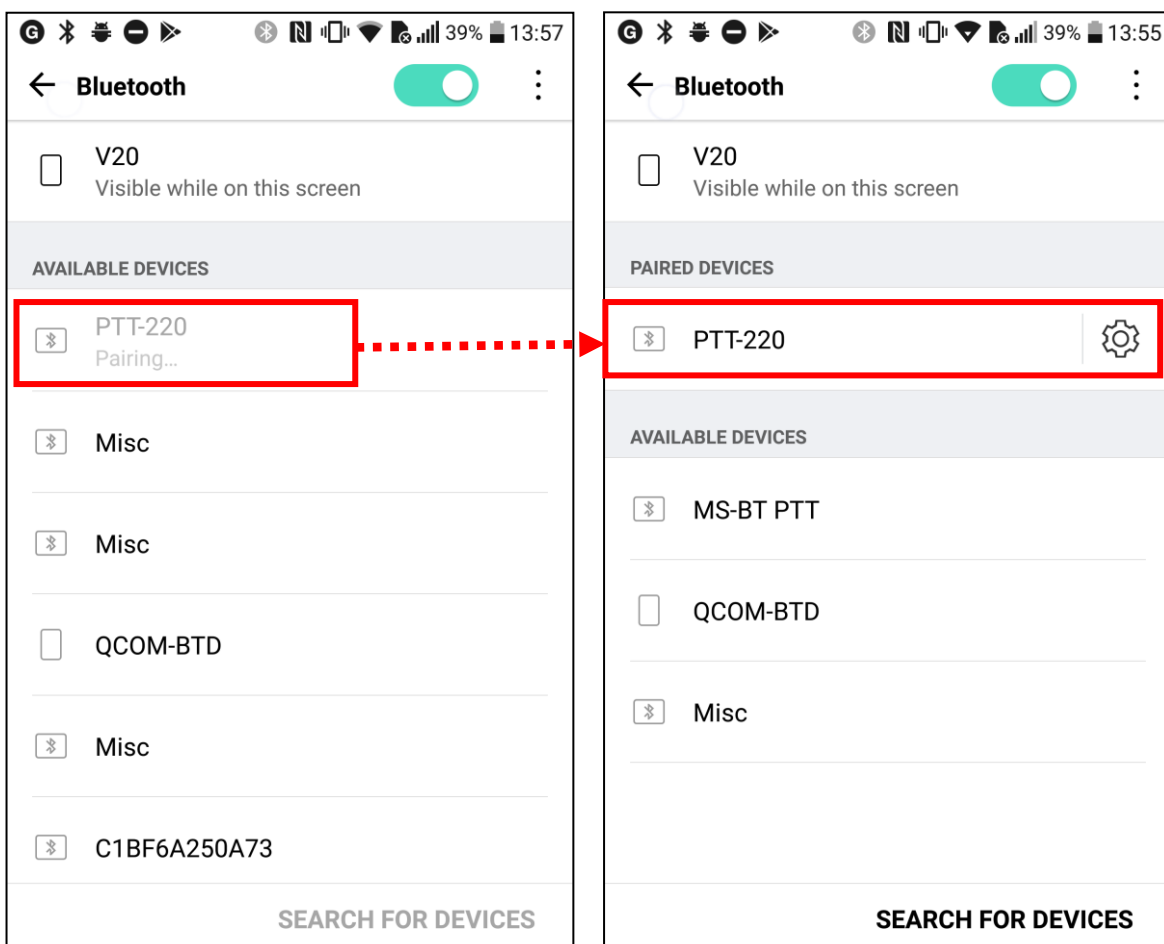



MobilitySound PTT-220-VZ

3. To set "Push-to-talk buttons" before using the PTT-220-VZ for "Zello" app:

a. First, open the "Zello" app, and click the three dots at the upper left.

b. Next, select the "Options".

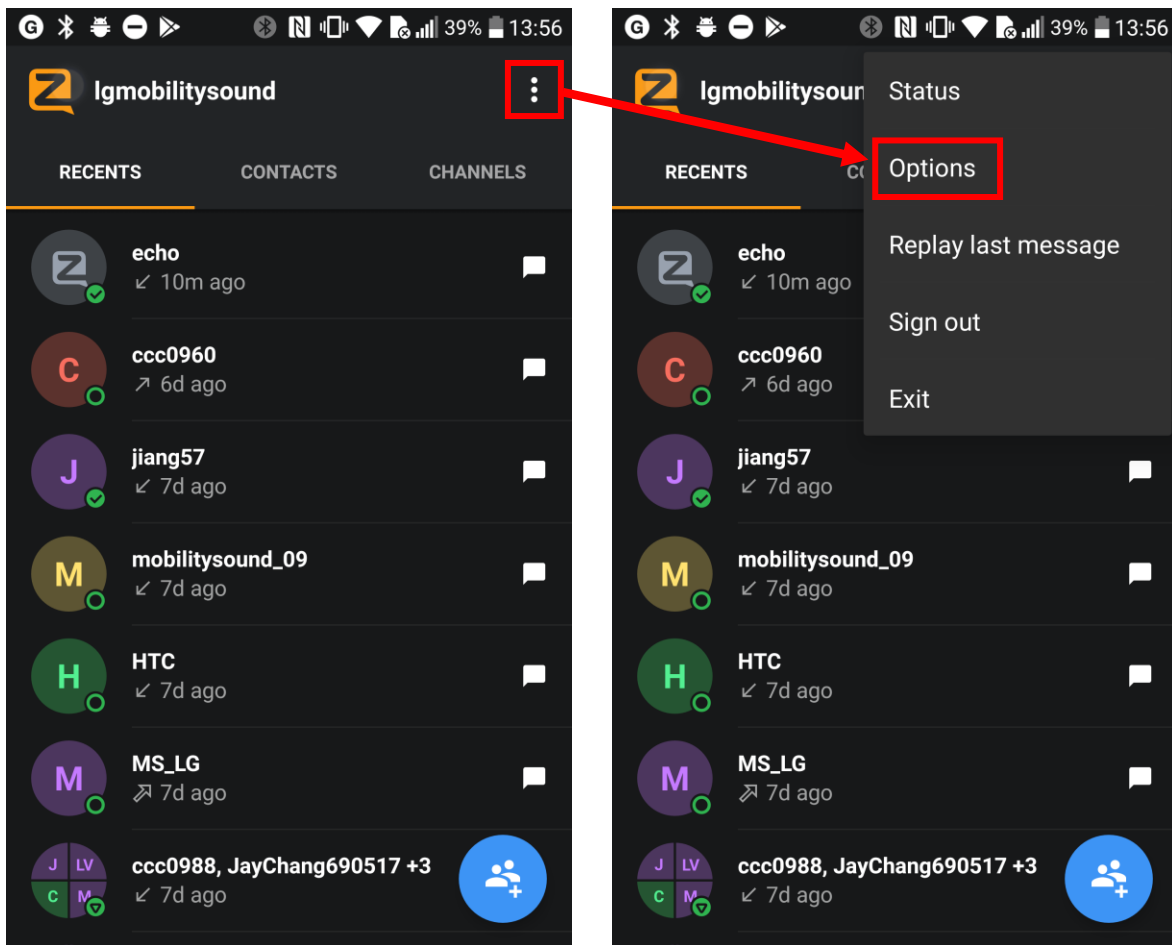



MobilitySound PTT-220-VZ

c. Third, select the "Push-to-talk buttons" and click the "Add" button. When the pop-up window of "Press and release..." is displayed, press the PTT button on PTT-220-VZ, and it will be connected with "Zello" app.

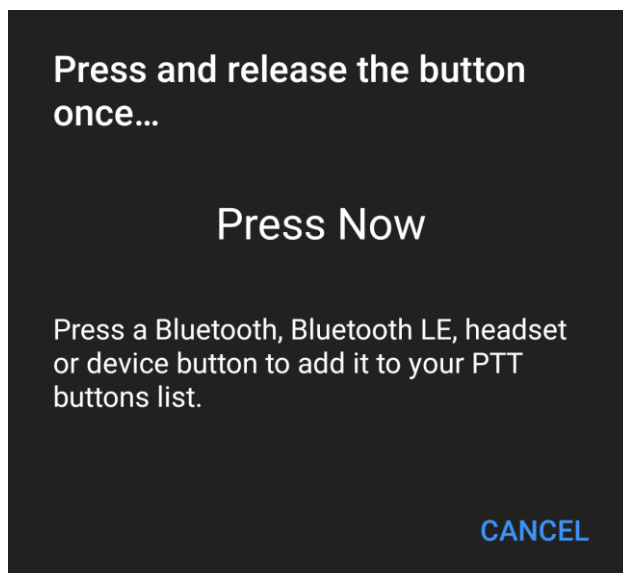
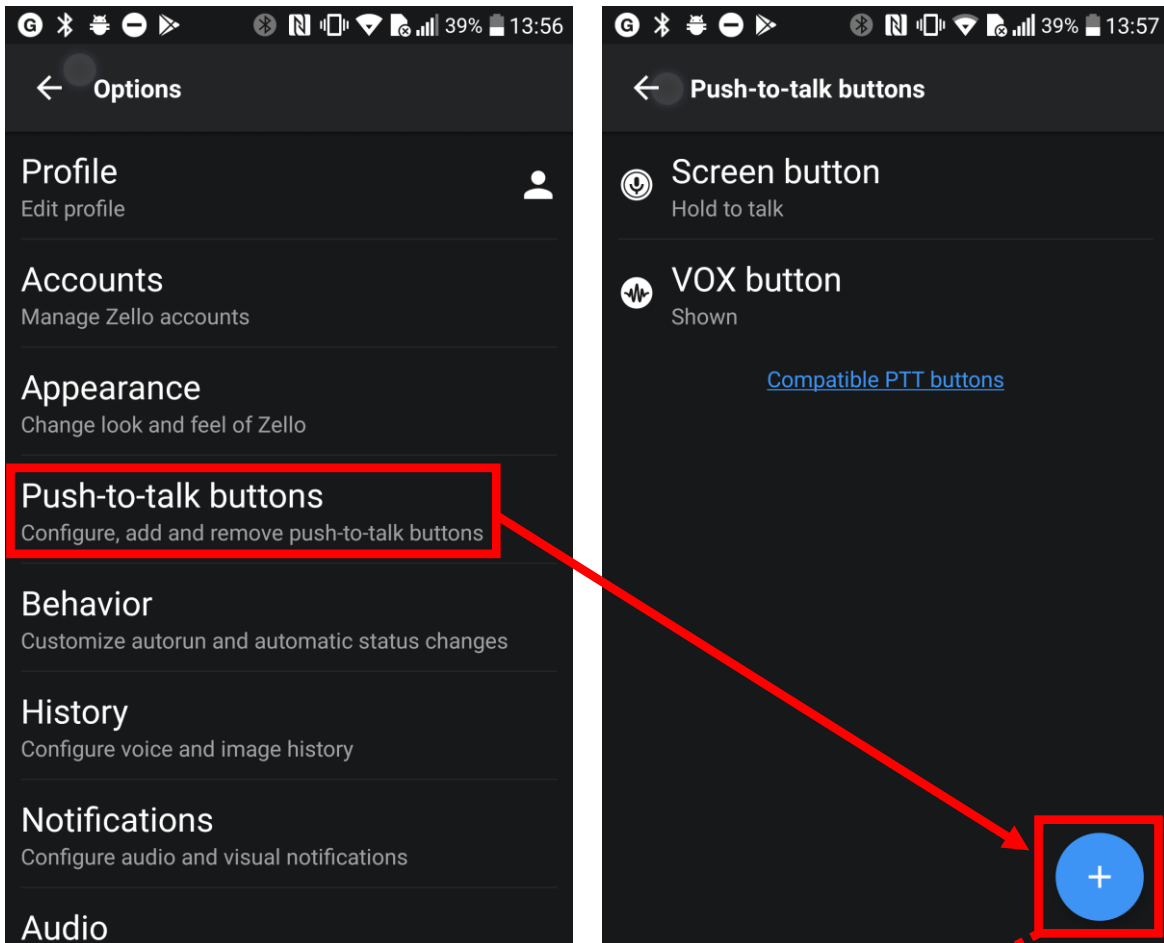



MobilitySound PTT-220-VZ

d. Last, the "PTT-220 (Hold to talk)" should display in the window. When you press the PTT button on the PTT-220-VZ, the LED will be red. Now you can use the PTT-220-VZ to work with "Zello" app.

